

# Model: ZP235KCE-TWD

## Data

---

**Type:** Hermetic scroll compressors

**Producer:** Copeland

**Series:** ZP

## Model: ZP235KCE-TWD

### Technical data

Displacement [m <sup>3</sup> /h]:	37,8
Sound power [dBA]:	82
Sound pressure level [dB]:	71
Net Weight [kg]:	140,0
Gross Weight [kg]:	168
Oil charge [dm <sup>3</sup> ]:	4,7
Maximum high pressure [bar]:	45
Maximum standstill pressure [bar]:	29,5
Minimal lowside temperature [°C]:	-35
Maximum lowside temperature [°C]:	50
PED category:	2

### Electrical data

Power supply [V/~/Hz]:	380-420V/3/50Hz
Locked rotor current [A]:	225,0
Max. operating current [A]:	40,0
Winding resistance [Ω]:	0,6

### Connections

	<u>inches</u>
Suction connection with supplied sleeve:	1 5/8"
Discharge connection with supplied sleeve:	1 3/8"

# Model: ZP235KCE-TWD

## Capacity

R410A

### Cooling capacity [kW]

<b>t<sub>c</sub> \ t<sub>e</sub></b>	<b>-20</b>	<b>-15</b>	<b>-10</b>	<b>-5</b>	<b>0</b>	<b>5</b>	<b>10</b>	<b>15</b>
<b>25</b>	26.21	32.53	39.93	48.52	58.43	69.78	82.66	97.22
<b>30</b>	24.42	30.48	37.57	45.79	55.26	66.10	78.43	92.36
<b>35</b>	22.69	28.48	35.23	43.05	52.06	62.38	74.12	87.40
<b>40</b>	21.01	26.50	32.89	40.28	48.81	58.57	69.70	82.31
<b>45</b>	-	24.51	30.51	37.45	45.47	54.66	65.15	77.06
<b>50</b>	-	-	28.06	34.53	42.01	50.61	60.44	71.63
<b>55</b>	-	-	-	31.50	38.41	46.39	55.53	65.98
<b>60</b>	-	-	-	-	34.64	41.97	50.41	60.08
<b>65</b>	-	-	-	-	30.67	37.32	45.03	53.90

### Power input [kW]

<b>t<sub>c</sub> \ t<sub>e</sub></b>	<b>-20</b>	<b>-15</b>	<b>-10</b>	<b>-5</b>	<b>0</b>	<b>5</b>	<b>10</b>	<b>15</b>
<b>25</b>	9.26	9.37	9.49	9.62	9.78	9.96	10.18	10.44
<b>30</b>	10.15	10.25	10.37	10.51	10.67	10.86	11.09	11.35
<b>35</b>	11.16	11.26	11.38	11.51	11.67	11.86	12.08	12.35
<b>40</b>	12.35	12.44	12.55	12.67	12.82	13.00	13.21	13.47
<b>45</b>	-	13.83	13.92	14.02	14.16	14.32	14.52	14.76
<b>50</b>	-	-	15.54	15.62	15.73	15.87	16.05	16.28
<b>55</b>	-	-	-	17.52	17.60	17.71	17.86	18.06
<b>60</b>	-	-	-	-	19.79	19.87	19.99	20.15
<b>65</b>	-	-	-	-	22.36	22.40	22.47	22.60

# Model: ZP235KCE-TWD

## Capacity

### Current [A]

<b>t<sub>c</sub> \ t<sub>e</sub></b>	<b>-20</b>	<b>-15</b>	<b>-10</b>	<b>-5</b>	<b>0</b>	<b>5</b>	<b>10</b>	<b>15</b>
<b>25</b>	19.34	19.45	19.56	19.69	19.85	20.09	20.42	20.86
<b>30</b>	20.44	20.59	20.72	20.84	20.99	21.18	21.44	21.79
<b>35</b>	21.67	21.88	22.03	22.16	22.29	22.44	22.64	22.92
<b>40</b>	23.09	23.36	23.55	23.69	23.81	23.93	24.08	24.29
<b>45</b>	-	25.07	25.31	25.47	25.59	25.70	25.81	25.95
<b>50</b>	-	-	27.36	27.56	27.69	27.78	27.86	27.94
<b>55</b>	-	-	-	30.00	30.15	30.24	30.29	30.33
<b>60</b>	-	-	-	-	33.02	33.11	33.14	33.14
<b>65</b>	-	-	-	-	36.34	36.45	36.47	36.44

### Mass flow [kg/h]

<b>t<sub>c</sub> \ t<sub>e</sub></b>	<b>-20</b>	<b>-15</b>	<b>-10</b>	<b>-5</b>	<b>0</b>	<b>5</b>	<b>10</b>	<b>15</b>
<b>25</b>	509.53	629.10	765.17	920.16	1 096.50	1 296.60	1 522.89	1 777.78
<b>30</b>	503.02	621.63	756.81	910.97	1 086.53	1 285.92	1 511.55	1 765.84
<b>35</b>	493.83	611.56	745.90	899.29	1 074.14	1 272.88	1 497.91	1 751.66
<b>40</b>	482.90	599.79	733.37	886.05	1 060.25	1 258.39	1 482.89	1 736.17
<b>45</b>	-	587.26	720.13	872.16	1 045.77	1 243.38	1 467.40	1 720.27
<b>50</b>	-	-	707.10	858.54	1 031.62	1 228.76	1 452.37	1 704.89
<b>55</b>	-	-	-	846.12	1 018.73	1 215.46	1 438.72	1 690.95
<b>60</b>	-	-	-	-	1 008.01	1 204.39	1 427.37	1 679.36
<b>65</b>	-	-	-	-	1 000.38	1 196.48	1 419.23	1 671.06

# Model: ZP235KCE-TWD

## Capacity

### C.O.P. [W/W]

$t_c \setminus t_e$	-20	-15	-10	-5	0	5	10	15
25	2.83	3.47	4.21	5.04	5.98	7.00	8.12	9.31
30	2.41	2.97	3.62	4.36	5.18	6.08	7.07	8.13
35	2.03	2.53	3.10	3.74	4.46	5.26	6.13	7.08
40	1.70	2.13	2.62	3.18	3.81	4.51	5.28	6.11
45	-	1.77	2.19	2.67	3.21	3.82	4.49	5.22
50	-	-	1.81	2.21	2.67	3.19	3.76	4.40
55	-	-	-	1.80	2.18	2.62	3.11	3.65
60	-	-	-	-	1.75	2.11	2.52	2.98
65	-	-	-	-	1.37	1.67	2.00	2.39

### Application range

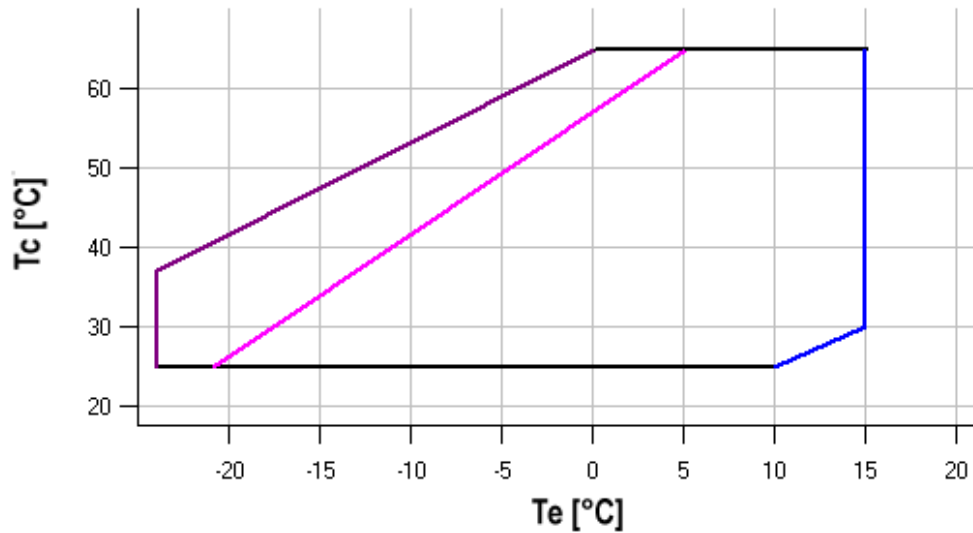

- Maximum evaporating temperature
- 25°C suction gas temperature
- 10K gas overheat

Operating conditions: 10K suction superheat, 0K subcooling

$t_c$  - Condensing temperature [°C]

$t_e$  - Evaporating temperature [°C]

# Model: ZP235KCE-TWD

## Dimensions

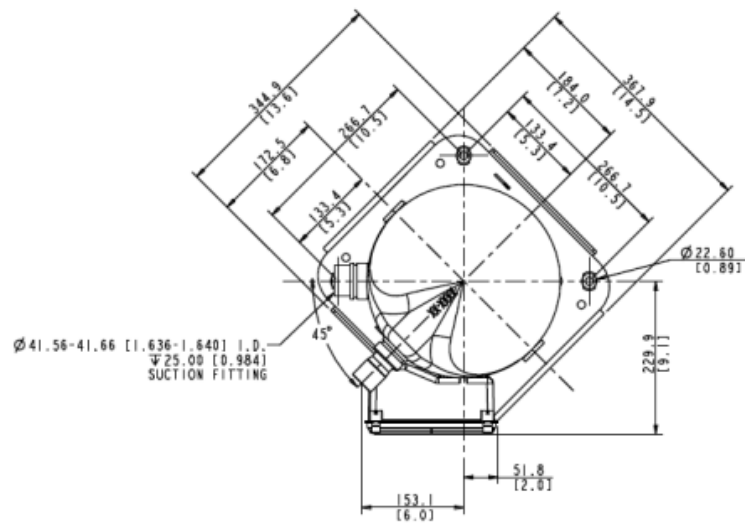
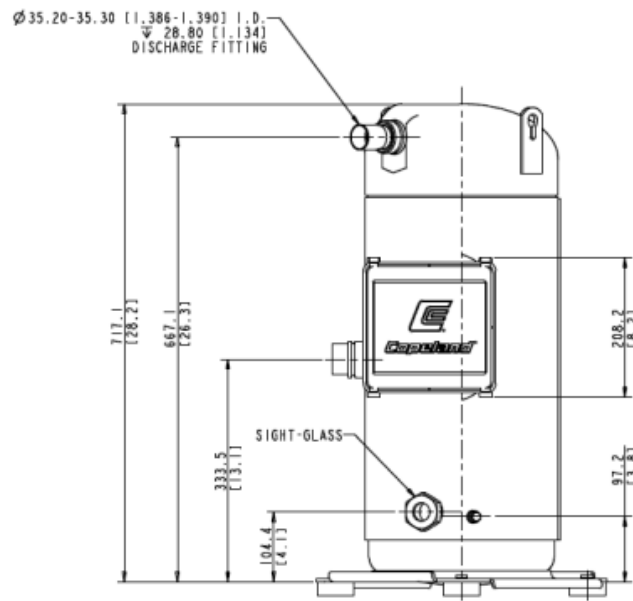

# Model: ZP235KCE-TWD

Image

---

